

HM Land Registry

Release of part of the land from a registered charge

DS3

This form should be accompanied by Form AP1.

Any parts of the form that are not typed should be completed in black ink and in block capitals.

If you need more room than is provided for in a panel, and your software allows, you can expand any panel in the form. Alternatively use continuation sheet CS and attach it to this form.

For information on how HM Land Registry processes your personal information, see our [Personal Information Charter](#).

Insert address including postcode (if any) or other description of the property, for example 'land adjoining 2 Acacia Avenue'.

Place 'X' in the appropriate box and complete the statement.

For example 'edged red'.

Any plan lodged must be signed by the lender.

For example 'edged and numbered 1 in blue'.

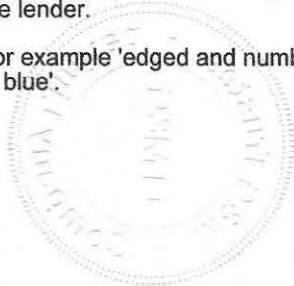

Complete as appropriate where the lender is a company.

1	Title number(s) of the property: MS493904
2	<p>Property released from the charge: 64A Palm Grove, Oxtou, CH43 1TG</p> <p>The property is identified</p> <p><input checked="" type="checkbox"/> on the attached plan and shown: edged red (ground floor flat only)</p> <p><input type="checkbox"/> on the title plan(s) of the above title(s) and shown:</p>
3	Date:
4	Date of charge:
5	<p>Lender: M&G Trustee Company Limited</p> <p><u>For UK incorporated companies/LLPs</u> Registered number of company or limited liability partnership including any prefix: 1863305</p> <p><u>For overseas companies</u> (a) Territory of incorporation:</p> <p>(b) Registered number in the United Kingdom including any prefix:</p>
6	The lender acknowledges that the property identified in panel 2 is no longer charged as security for the payment of sums due under the charge
7	Date of Land Registry facility letter, (if any):

Insert any agreed provisions as to rights granted or other matters.

8 Additional provisions

The lender must execute this as a deed using the space opposite. If there is more than one lender, all must execute. Forms of execution are given in Schedule 9 to the Land Registration Rules 2003.

Alternatively the lender may sign in accordance with the facility letter referred to in panel 7.

9 Execution

EXECUTED AS A DEED BY AFFIXING THE COMMON
SEAL OF M&G TRUSTEE COMPANY LIMITED
IN THE PRESENCE OF

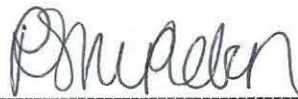

Rose Stapleton

SEALING OFFICER



WARNING

If you dishonestly enter information or make a statement that you know is, or might be, untrue or misleading, and intend by doing so to make a gain for yourself or another person, or to cause loss or the risk of loss to another person, you may commit the offence of fraud under section 1 of the Fraud Act 2006, the maximum penalty for which is 10 years' imprisonment or an unlimited fine, or both.

Failure to complete this form with proper care may result in a loss of protection under the Land Registration Act 2002 if, as a result, a mistake is made in the register.

Under section 66 of the Land Registration Act 2002 most documents (including this form) kept by the registrar relating to an application to the registrar or referred to in the register are open to public inspection and copying. If you believe a document contains prejudicial information, you may apply for that part of the document to be made exempt using Form EX1, under rule 136 of the Land Registration Rules 2003.



KEY

 Boundary

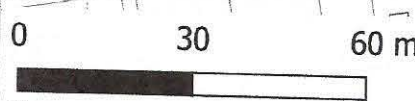
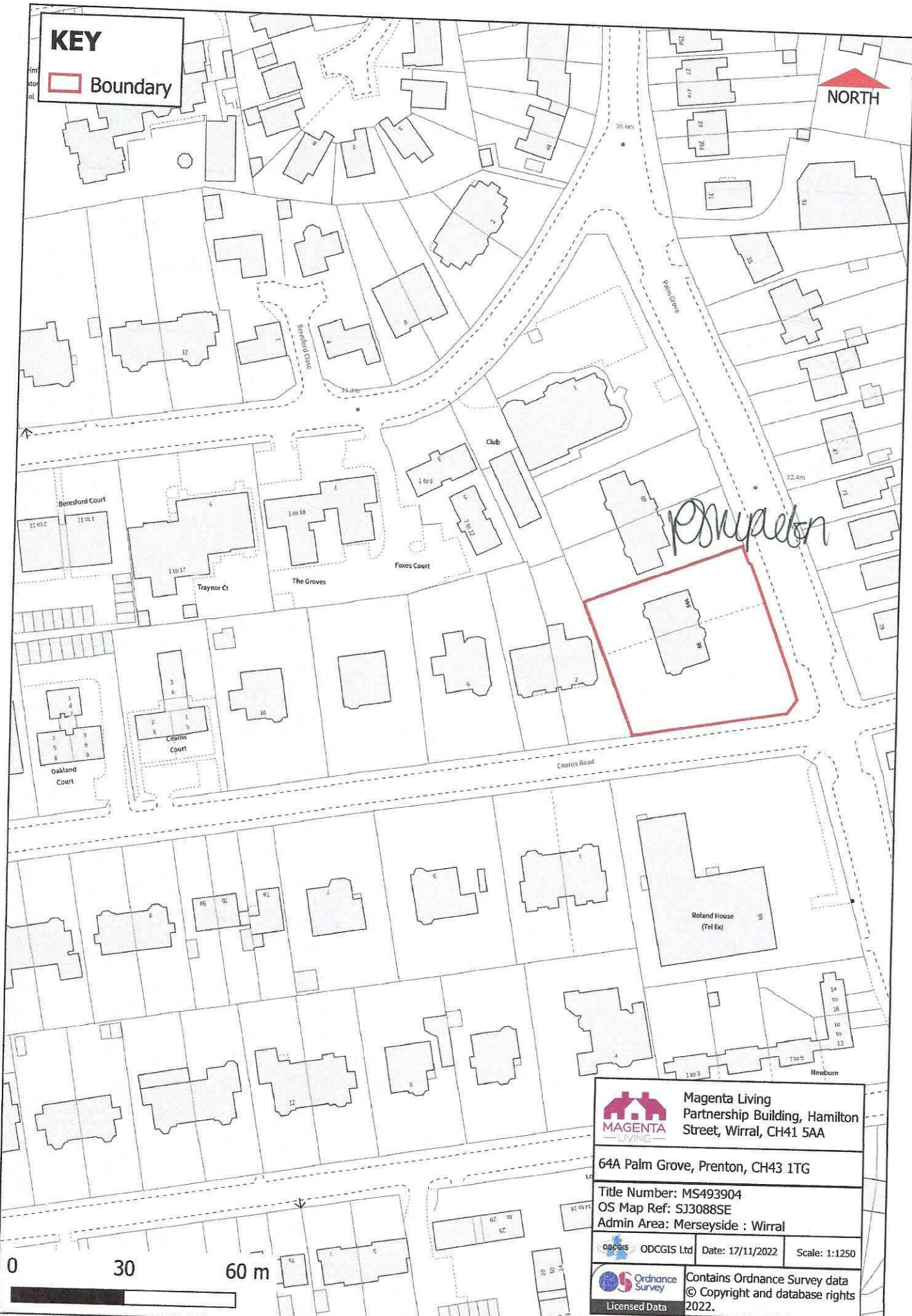

Preparation



	Magenta Living Partnership Building, Hamilton Street, Wirral, CH41 5AA	
64A Palm Grove, Prenton, CH43 1TG		
Title Number: MS493904		
OS Map Ref: SJ3088SE		
Admin Area: Merseyside : Wirral		
 ODCGIS Ltd	Date: 17/11/2022	Scale: 1:1250
	Contains Ordnance Survey data © Copyright and database rights 2022.	
Licensed Data		

